

6101 Glenridge Road (3554.9 sf HLA)

First Floor
2190.6sf

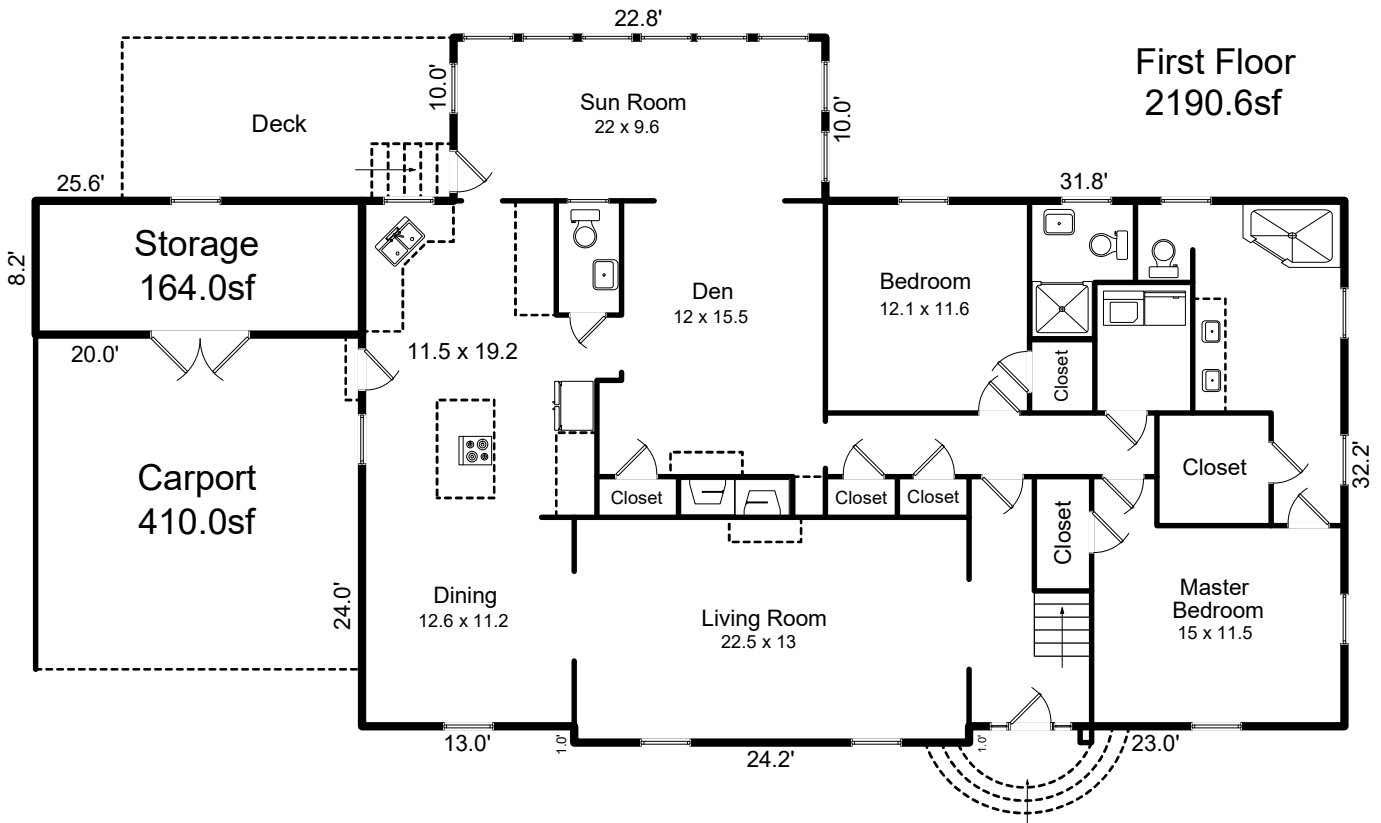

Second Floor
1364.3sf

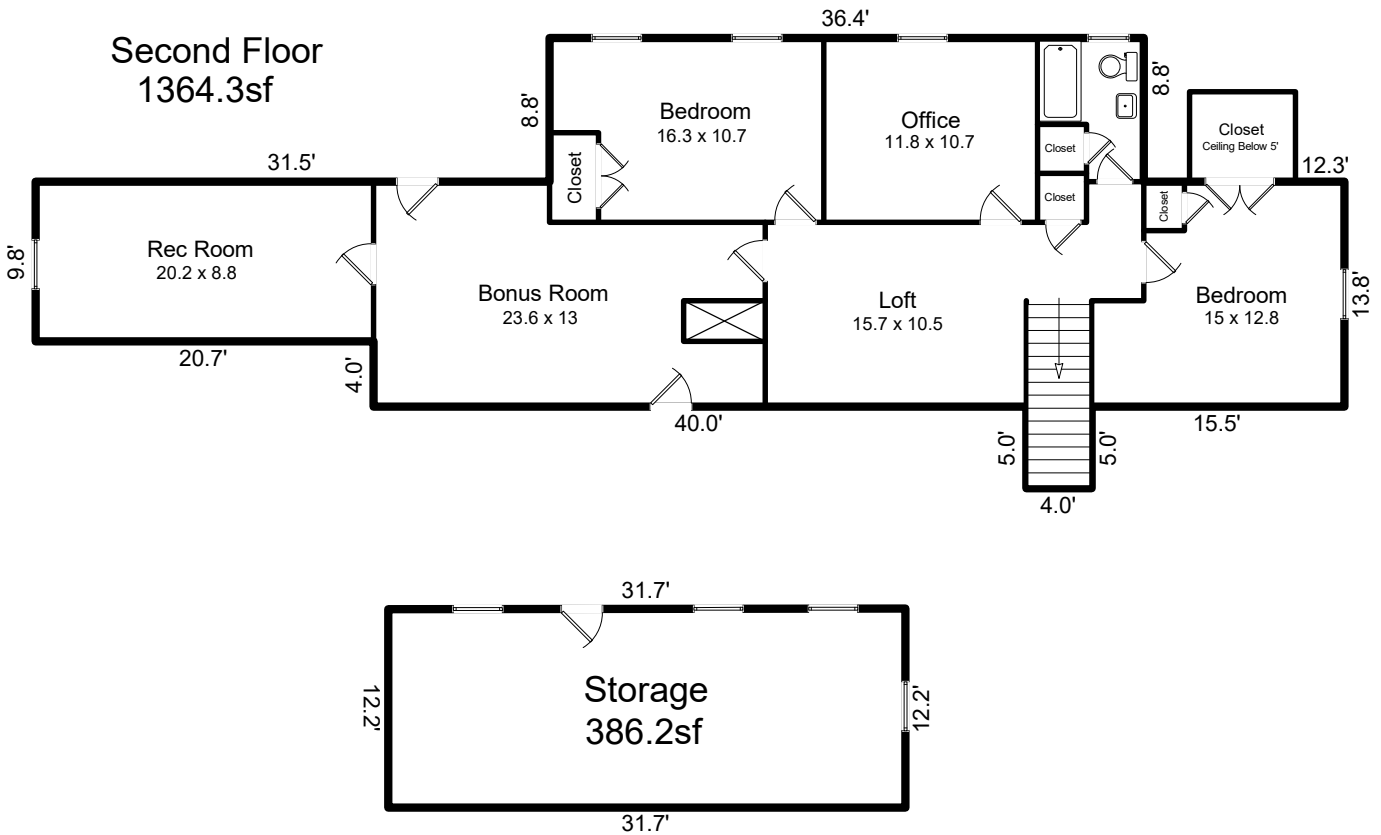

SKETCH/AREA TABLE ADDENDUM

SUBJECT INFO

File No.:	Parcel No.:		
Property Address:			
City:	County:	State:	ZipCode:
Owner:			
Client:		Client Address:	
Appraiser Name:		Inspection Date:	

SKETCH

First Floor (GLA1)

$$24.20 \times 1.00 = 24.20$$

$$22.80 \times 10.00 = 228.00$$

$$60.20 \times 32.20 = 1938.44$$

Carport (GAR)

$$20.50 \times 20.00 = 410.00$$

Storage (OTH)

$$8.20 \times 5.30 = 43.46$$

$$14.70 \times 8.20 = 120.54$$

Deck (P/P)

$$10.00 \times 5.60 = 56.00$$

$$14.70 \times 10.00 = 147.00$$

Second Floor (GLA2)

$$5.00 \times 4.00 = 20.00$$

$$80.20 \times 9.80 = 785.96$$

$$59.50 \times 4.00 = 238.00$$

$$36.40 \times 8.80 = 320.32$$

Storage (OTH)

$$0.5 \times 31.70 \times 0.03 = 0.55$$

$$31.70 \times 12.17 = 385.64$$